

1980-81 - FOREST GROVE HIGH SCHOOL PROJECT HOUSE
 SCALE 1/4" = 1'-0" TOTAL SQUARE FEET - 1788'-0"

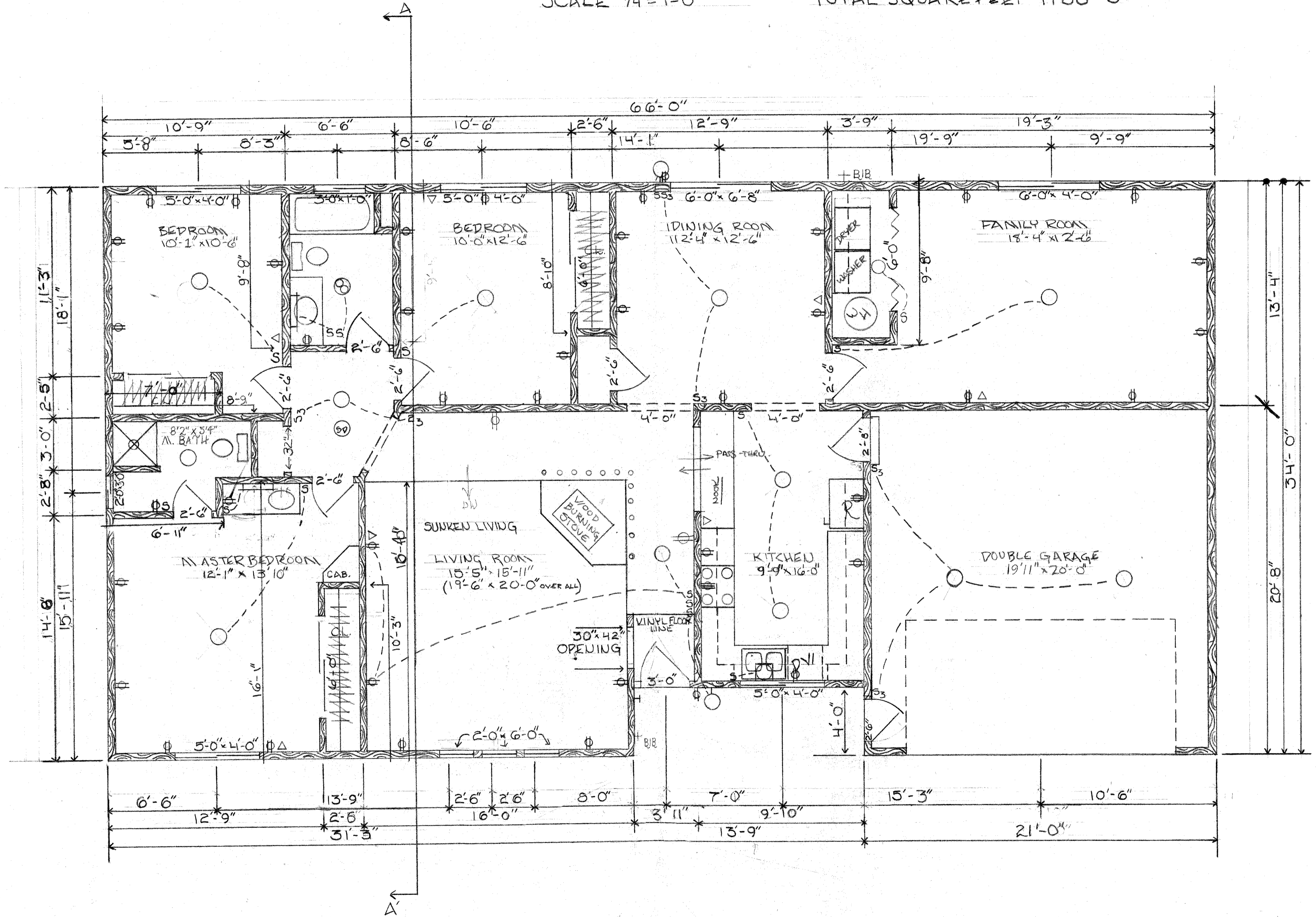

SCOTT MODRELL	MAY 2 1980
FOREST GROVE HIGH SCHOOL ARCHITECTURAL DRAFTING II	

VH 1981